

# In-Wall Wi-Fi SOUNDAROUND Controller

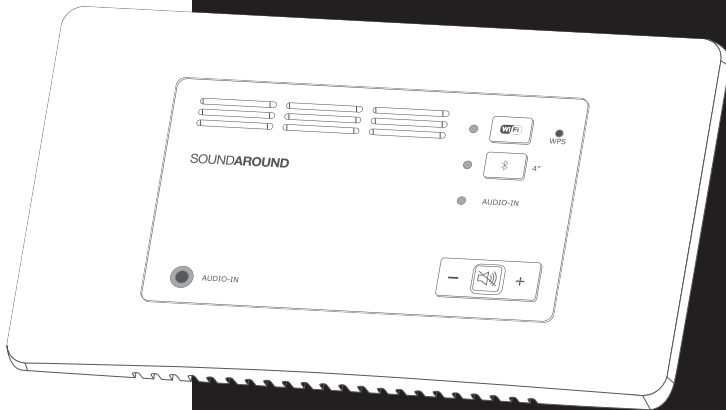

**eISSOUND**  
**KBSOUND®**

**FCC compliance information**

This device complies with Part 15 of the FCC Rules. Operation is subject to the following two conditions: (1) this device may not cause harmful interference, and (2) this device must accept any interference received, including interference that may cause undesired operation.

This product does not contain any user serviceable components. Any unauthorized product changes or modifications will invalidate warranty and all applicable regulatory certifications and approvals, including authority to operate this device.

This equipment has been tested and found to comply with the limits for a Class B digital device, pursuant to part 15 of the FCC Rules. These limits are designed to provide reasonable protection against harmful interference in a residential installation. This equipment generates, uses and can radiate radio frequency energy and, if not installed and used in accordance with the instructions, may cause harmful interference to radio communications. However, there is no guarantee that interference will not occur in a particular installation. If this equipment does cause harmful interference to radio or television reception, which can be determined by turning the equipment off and on, the user is encouraged to try to correct the interference by one or more of the following measures:

- Reorient or relocate the receiving antenna.
- Increase the separation between the equipment and receiver.
- Connect the equipment into an outlet on a circuit different from that to which the receiver is connected to.
- Consult the dealer or an experienced radio/TV technician for help.

Operations in the 5.15-5.25GHz band are restricted to indoor usage only.

The product comply with the FCC portable RF exposure limit set forth for an uncontrolled environment and are safe for intended operation as described in this manual. The further RF exposure reduction can be achieved if the product can be kept as far as possible from the user body or set the device to lower output power if such function is available.

**Industry Canada notice**

This equipment complies with Canadian RSS-210. This device complies with Industry Canada licence-exempt RSS standard(s). Operation is subject to the following two conditions: (1) this device may not cause interference, and (2) this device must accept any interference, including interference that may cause undesired operation of the device.

Le présent appareil est conforme aux CNR-210 d'Industrie Canada applicables aux appareils radio exempts de licence. L'exploitation est autorisée aux deux conditions suivantes: (1) l'appareil ne doit pas produire de brouillage, et (2) l'utilisateur de l'appareil doit accepter tout brouillage radioélectrique subi, même si le brouillage est susceptible d'en compromettre le fonctionnement.

Caution: (i) the device for operation in the band 5150-5250 MHz is only for indoor use to reduce the potential for harmful interference to co-channel mobile satellite systems; (ii) the maximum antenna gain permitted for devices in the bands 5250-5350 MHz and 5470-5725 MHz shall comply with the e.i.r.p. limit; and (iii) the maximum antenna gain permitted for devices in the band 5725-5825 MHz shall comply with the e.i.r.p. limits specified for point-to-point and non point-to-point operation as appropriate. (iv) Users should also be advised that high-power radars are allocated as primary users (i.e. priority users) of the bands 5250-5350 MHz and 5650-5850 MHz and that these radars could cause interference and/or damage to LE-LAN devices.

Avertissement: Le guide d'utilisation des dispositifs pour réseaux locaux doit inclure des instructions précises sur les restrictions susmentionnées, notamment : (i) les dispositifs fonctionnant dans la bande 5 150-5 250 MHz sont réservés uniquement pour une utilisation à l'intérieur afin de réduire les risques de brouillage préjudiciable aux systèmes de satellites mobiles utilisant les mêmes canaux; (ii) le gain maximal d'antenne permis pour les dispositifs utilisant les bandes 5 250-5 350 MHz et 5 470-5 725 MHz doit se conformer à la limite de p.i.r.e.; (iii) le gain maximal d'antenne permis (pour les dispositifs utilisant la bande 5 725-5 825 MHz) doit se conformer à la limite de p.i.r.e. spécifiée pour l'exploitation point à point et non point à point, selon le cas. (iv) De plus, les utilisateurs devraient aussi être avisés que les utilisateurs de radars de haute puissance sont désignés utilisateurs principaux (c.-à-d., qu'ils ont la priorité) pour les bandes 5 250-5 350 MHz et 5 650-5 850 MHz et que ces radars pourraient causer du brouillage et/ou des dommages aux dispositifs LAN-EL.

The product comply with the Canada portable RF exposure limit set forth for an uncontrolled environment and are safe for intended operation as described in this manual. The further RF exposure reduction can be achieved if the product can be kept as far as possible from the user body or set the device to lower output power if such function is available.

## Important Safety Instructions

1. Please read, keep and follow these instructions.
2. Heed all warnings.
3. **WARNING:** *To reduce the risk of fire or electric shock, do not expose this apparatus to rain or moisture. This product is not an outdoor product. It is only for indoor use.*
4. Clean only with a dry cloth.
5. Do not block any ventilation openings or the port hole at the rear side of the product. Install in accordance with the manufacturer's instructions.
6. Do not install near any heat sources such as radiators, heat registers, stoves, or other apparatus (including amplifiers) that produce heat.
7. Only use attachments/accessories specified by the manufacturer.
8. Operate this product only from the type of power source indicated on the back panel.
9. Keep this product a safe distance away from naked flame, such as a lit candle.
10. When replacement parts are required, be sure your technical service used replacement parts specified by the manufacturer or have the same features as the original part. Unauthorized substitutions may result in fire, electric shock or other damages.
11. The recommended operating temperature range is from 5°C to 40°C (41°F – 104°F).
12. **WARNING:** *Although the product is in OFF mode it is connected to the mains.*



This symbol is intended to alert the user to the presence of uninsulated "dangerous voltage" within the product's enclosure that may be of sufficient magnitude to constitute a risk of electric shock to persons.



This symbol is intended to alert the user to the presence of important operating and maintenance (servicing) instructions in the literature accompanying the appliance.



This equipment is a Class II or double insulated Electrical appliance. It has been designed in such away that it does not require a safety connection to electrical earth.



### DISPOSAL

This product can be recycled. Products bearing this symbol must NOT be thrown away with normal household waste. At the end of the product's life, take it to a collection point designated for recycling of electrical and electronic devices. Find out more about return and collection points through your local authority. The European Waste Electrical and Electronic Equipment (WEEE) Directive was implemented to dramatically reduce the amount of waste going to landfills, thereby reducing the environmental impact on the planet and on human health. Please act responsibly by recycling used products. If this product is still useable, consider giving it away or selling it.

Our Wi-Fi SOUNDAROUND range comprises the In Wall Wi-Fi SOUNDAROUND Controller, together with our standalone SOUNDAROUND Wi-Fi Speakers SA 30W & SA 50W.

The In Wall Wi-Fi SOUNDAROUND Controller is focused on the building industry and for installation purposes. The standalone SOUNDAROUND Wi-Fi Speakers SA 30W & SA 50W are complementary and portable products that co-exist with the In Wall Controller.

POWERED BY

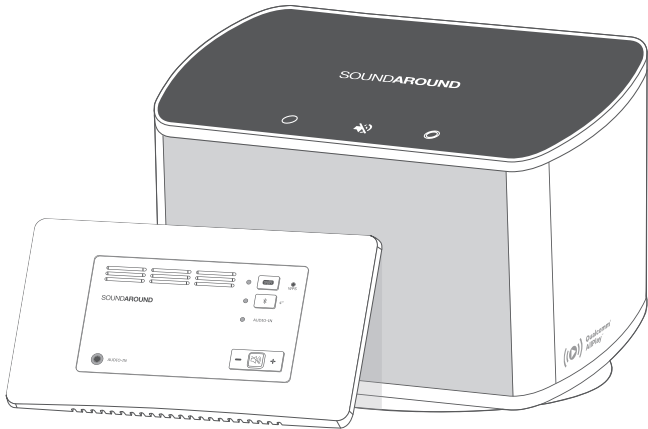

**Qualcomm®  
AllPlay™ Radio**

powered by  
**tunein**



---

<b>1. Keypad Description</b>	6
<b>2. Installation and power requirements</b>	6
<b>3. Led Display</b>	11
<b>4. Setup</b>	12
4.1 Minimum requirements	12
4.2 Download the App	12
4.3 Connecting your SOUNDAROUND Controller to a Wi-Fi network	13
4.3.1 Web Browser Method	13
4.3.2 WPS Button Method	15
4.3.3 Via App	15
4.3.4 Ethernet hardwired connection	17
<b>5. Play Music</b>	17
5.1 Wi-Fi Mode	17
5.2 Bluetooth Mode	20
5.3 Audio- In Mode	21
<b>6. Settings</b>	23
<b>7. FAQ's</b>	25
<b>8. Specifications</b>	28

---

# 1. Keypad Description

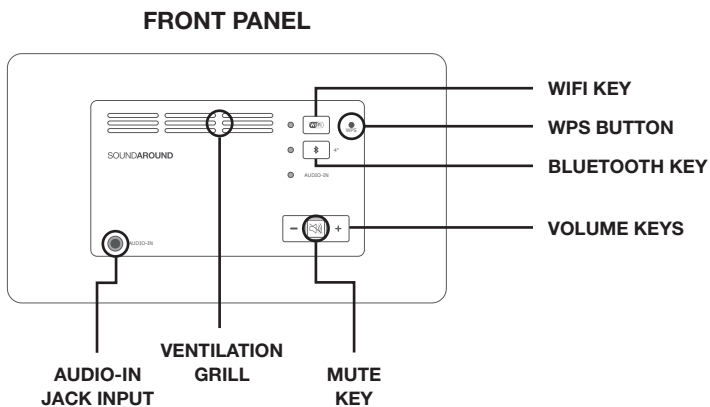

# 2. Installation and power requirements

## Basic Installation

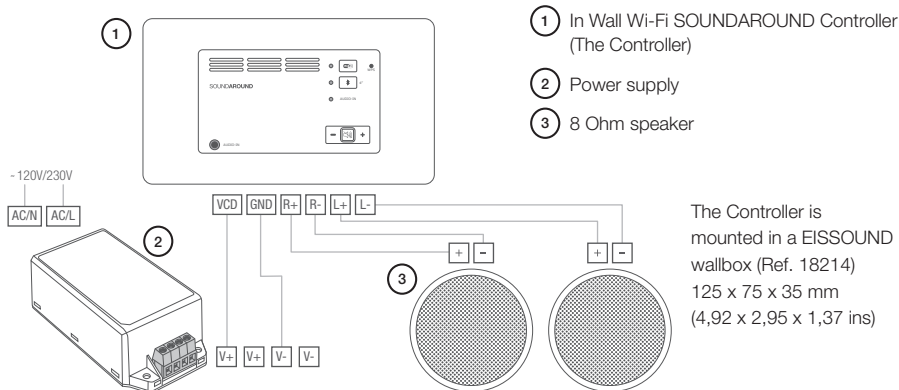

## Power Requirements

The Controller is powered from an external power supply unit. Any 24Vdc, 15Vdc, 12Vdc power supply may be used depending on the audio output needed and the number of Controllers installed.

OUTPUT AUDIO POWER				
		Speaker Impedance		
		4 ohms	8 ohms	16 ohms
<b>Power</b>	24Vdc	----	25+25W	15+15W
<b>Supply</b>	15Vdc	16+16W	10+10W	5,5+5,5W
<b>Voltage</b>	12Vdc	10+10W	6+6W	3,5+3,5W

CONSUMPTION				
		Speaker Impedance		
		4 ohms	8 ohms	16 ohms
<b>Power</b>	24Vdc	----	60W	44W
<b>Supply</b>	15Vdc	45W	27W	18W
<b>Voltage</b>	12Vdc	30W	18W	14W

## 2.1 INSTALLATION GUIDE

### 2.1.1 Advice

It is recommended to place the router in a place where the Wi-Fi signal will be equally distributed throughout the home or installation.

Beware of the following physical obstacles when placing the Controllers and the other wireless devices, such as the router. Some surfaces may absorb the Wi-Fi signal and cause signal loss and unwanted behavior.

MATERIAL	INTERFERENCE LEVEL
Wood	Low
Synthetic	Low
Glass	Low
Water	Medium
Brick	Medium
Marble	Medium
Plaster	High
Reinforced cement	High
Metal	Very High

Wireless interference occurs when two or more wireless devices compete for the same Wi-Fi band, which can lead to performance problems. Be aware if any of the following devices are installed in the same area as the Controllers and router and keep them as far as possible (minimum distance between each other of 50cm): 2.4 GHz or DECT cordless phones, wireless video transmitters that operate on the 2.4GHz or 5GHz Wi-Fi band, microwaves, wireless security cameras, wireless access points and extenders, 2.4 GHz baby monitors, garage door opener devices, wireless photo frames...

Router minimum requirements: Router Wi-Fi 802.11n with WPA2-PSK (AES) encryption, 5GHz highly recommended.

Smartphone/tablet minimum requirements: ANDROID 4.1 / iOS 7.0 and later.

### 2.1.2 Controller location

Choose the correct location for the Controllers. Take care about the installation recommendations above.



Install the EISSOUND in-wall box (Ref. 18214) or make a cavity with the following dimensions.

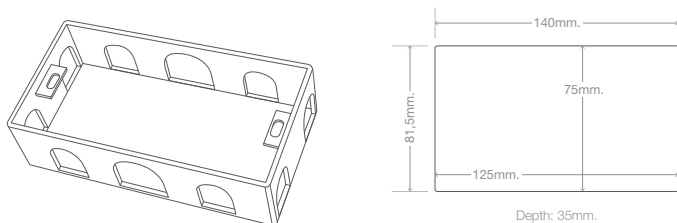

### 2.1.3 Wiring

Insert in the box the wires of the power supply unit, speaker cables and, optionally, the Ethernet cable. For the best performance of the system we recommend the option with the Ethernet hardwired connection.

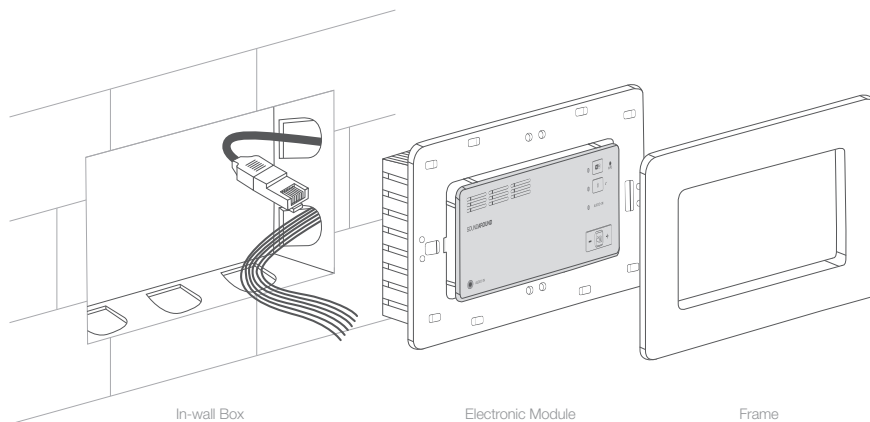

**2.1.4 Connection and switches setup**

- Connect the wires to the Controller Terminals.
- Connect the Ethernet connector to the Controller if applicable.
- Select the switches to choose the volume level audio output (maximum, medium, low) and the mono/stereo sound output.

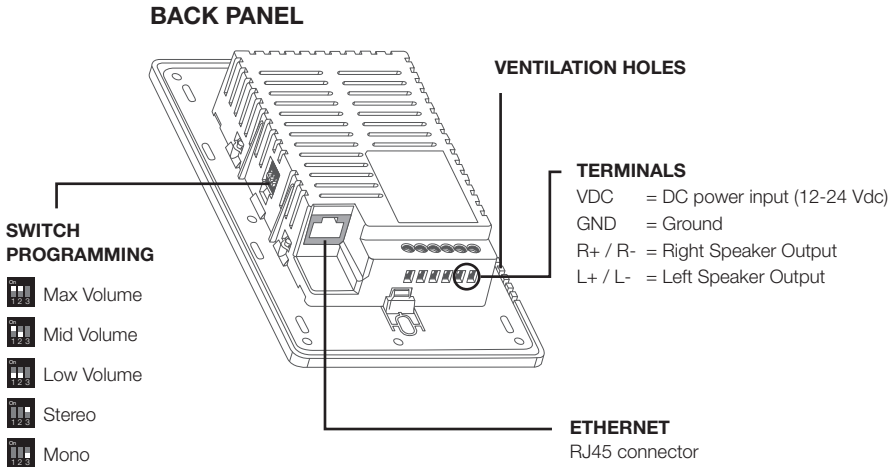

**2.1.5 Installing the Controller**

Insert the Controller in the wall and secure with screws.

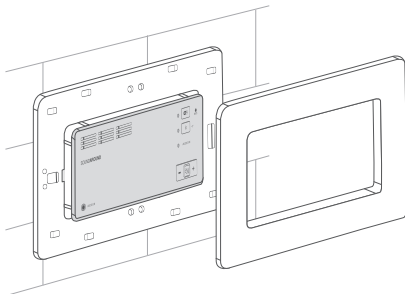

Fix the frame to the Controller.  
Take care about the position of the frame: the ventilation holes must be at the bottom, NOT at the top (the frame has one unique position).

### 2.1.6 Power-on

Turn on the power supply unit. The 3 leds will flash simultaneously for 40". Wait until Wi-Fi led flashes in white.

### 2.1.7 Network Setup

To setup the Controller to the network, follow the steps in chapter 4.

## 3. Led Display

### Music Options

MODE	LED	REBOOTING	STATUS
Wi-Fi	White flashing slowly	Rebooting (40")	Searching Wi-Fi network
	White flashing fast		Wi-Fi connection in process
	White ON		Wi-Fi connected (audio OFF)
	Green ON		SPOTIFY Streaming
	Blue ON		Wi-Fi streaming (audio ON)
BT	Blue flashing slowly	Rebooting (40")	Waiting connection with BT device previously paired (60")
	Blue flashing fast		BT pairing process
	Blue ON		BT connected
AUDIO-IN	Red flashing slowly	Rebooting (40")	
	Red ON		AUDIO-IN activated (audio ON)

## General LED Status

**Standby:** All leds will go OFF after 2 minutes of inactivity.

**Vol - / + :** Led flashes with volume increase / decrease.

**Reset to Factory default:** All leds flash simultaneously (white, blue and red).

**Firmware updated:** The Wi-Fi led flashes in different colors.

**Mute:** The led flashes slowly. Audio is muted but streaming continues to be received.

# 4. Setup

## 4.1 MINIMUM REQUIREMENTS

- Wi-Fi Router 802.11n, with WPA2-PSK encryption (AES).
- For Multiroom we recommend a 5 GHz multimedia router (speed> 600 Mbps).
- For best operation, the router should be placed at the center of the home or installation.
- Smartphone/Tablet requirements: ANDROID 4.1 minimum, iOS 7.0 minimum

## 4.2 DOWNLOAD THE APP



### APPLE USERS

Tap the Apple App Store on the iOS Device to download the **ALLPLAY JUKEBOX APP**



### ANDROID USERS

Tap the Google Play Store on the ANDROID Device to download the **ALLPLAY JUKEBOX APP**

### 4.3 CONNECTING YOUR IN WALL WI-FI SOUNDAROUND CONTROLLER TO A WI-FI NETWORK

#### 4.3.1 Web Browser Method

To set up the Controller press the Wi-Fi key for 8". Immediately the three leds will flash simultaneously. Wait until the Wi-Fi led flashes slowly in white.

Go to the Wi-Fi settings in your smartphone/tablet and search for the S-AROUND IWW (+ six characters, which are the Controller's unique MAC address-hardware). You will need to wait about 1 minute before the SOUNDAROUND Controller appears. Select the Controller. The Wi-Fi led flashes fast to indicate that the Controller is waiting to setup the network connection.

Automatically the smartphone/tablet default web browser launches and re-directs to the login web page.

If it does not redirect automatically, then open a web browser on your smartphone/tablet (safari, google chrome) and in the search bar enter the following IP Address number:

**172.19.42.1 Press enter.**

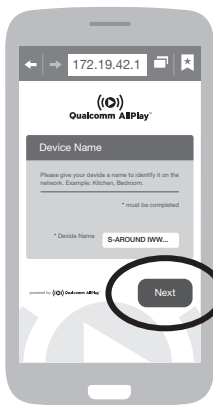

You will then be requested to name your Controller e.g. Kitchen, Bedroom, Gym... When done, press next.

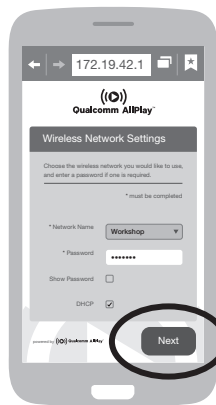

Now select your Wi-Fi network from the network list, enter your password, press Next and then Connect when finished.

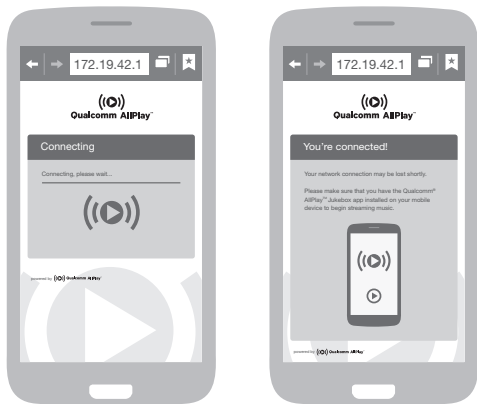

When connected to your network the Wi-Fi Led on the Controller will turn ON in white. The smartphone/tablet will automatically disconnect from the Controller and reconnect with your previous network connection.

**Note:** : If your network router does not assign an IP address automatically, switch the DHCP function to OFF and then enter the IP address manually. Then enter the network key again if required, and press “CONNECT”.

The Controller saves the connection and it will not be necessary to setup the connection again. It will connect automatically.

### 4.3.2 WPS Button Method

Please check beforehand that your router has a WPS key function.

To set up the Controller press the Wi-Fi key for 8". Immediately the three leds will flash simultaneously. Wait until the Wi-Fi led flashes slowly in white.

- Press the WPS button in the front of the Controller by inserting a non-metallic sharp object into the WPS hole. The Wi-Fi led flashes fast to indicate that the Controller is waiting to setup the network connection.
- Press the WPS button on your Wi-Fi Router. Connection should be automatic but you can refer to the LED indication chart above if you are unsure.
- When connected to your network the Wi-Fi Led on the Controller will turn ON in white.
- The Controller will appear with the factory default identifier (SOUNDAROUND CONTROLLER). To personalize the name open the settings menu on your App.

### 4.3.3 App Method

#### For iOS Users

Not applicable.

#### For ANDROID Users

Press the Wi-Fi key for 8" on the Controller. Immediately the three leds will flash simultaneously and wait until the Wi-Fi led flashes slowly in white.

Open the ALLPLAY JUKEBOX app and go to the “Select a player” menu list and Press the “+” button to add the Controller to the network.

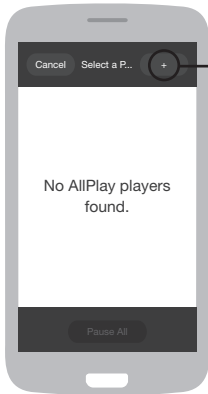

Open the App and go to the “Select a player” list.  
**Press the “+” button to add one Controller**

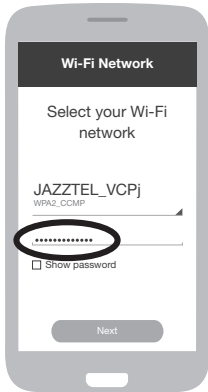
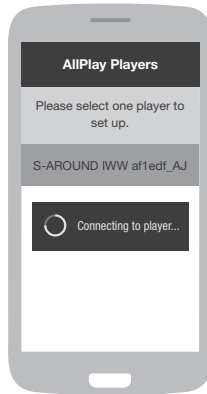

Select your Wi-Fi network in the network list and enter your password. Select Next.

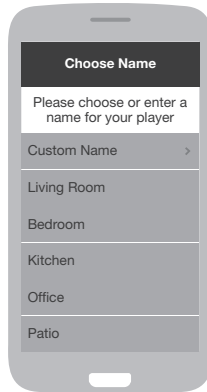

Name your controller.



#### 4.3.4 Ethernet hardwired connection

If your Controller has a wired network once you set up your router the Wi-Fi Led on the Controller will turn ON in white.

- The controller will appear with the factory default identifier (SOUNDAROUND CONTROLLER). To personalize the name open the settings menu on your App.

## 5. Play Music

Make sure your smartphone/tablet, audio devices and the Controllers are all connected to the same Wi-Fi network.

### 5.1 WI-FI MODE

The Controller is automatically in Wi-Fi mode and the Wi-Fi led is ON in white. To select the Wi-Fi mode press the Wi-Fi key on the front panel of your Controller.

Open the ALLPLAY JUKEBOX App in your smartphone/tablet, after a few seconds you will see the list of the Controllers you have already set up (Living room, Bedroom, kitchen, Gym or, whatever).

Select the room/area to which you want to stream music. The App will open the menu to select the music sources. In Wi-Fi mode the options are:

- A. Music on the device
- B. Music on the network
- C. Music services

### A. Music on the Device

Play music that is stored on your device.

### B. Music on the Network

The App locates the DLNA servers connected to your home network. It can be a NAS (network attached storage), a computer with DLNA server function (windows 7 and above). There are various DLNA server software for Windows and OSX, for example Serviio, Plex, EyeConnect, DivxPlayer.

### C. Music Services

Play Music via an alternative App. Your Controller and the ALLPLAY JUKEBOX allow you to stream on-line music like Spotify, Rhapsody, Napster and more. Open the Music Service tab, select and open the App and play the music. You may need to be registered and for certain Apps such as Spotify Premium fees may apply. If you use Sportify the led will be ON in green.

- **Internet Radio:** One of the featured Apps is Qualcomm® AllPlay™ Radio, powered by Tunein Radio. This App allows you to listen to more than 100,000 internet radio stations worldwide.

***Warning:** The Apps contained in Music Services (such as Spotify) run on different releases from different operating systems, using different devices from different brands. As a result, their functioning may present some differences between devices with the Jukebox App.*

#### 5.1.1 Play Music Options In Wi-Fi Mode

The App offers the following options:

#### 5.1.2 Party Mode

Several smartphones/tablets can play and add music tracks to a shared playlist which is then played in a specific room/area (Controller) or in the rooms/areas that have been grouped together. (see Multiroom mode).

### 5.1.3 Multiuser - Multizone Mode

A user can play different music tracks simultaneously in different rooms/areas (Controllers) from the same smartphone/tablet.

Several smartphones/tablets (users) can play and add music tracks simultaneously in different rooms/areas (Controllers).

### 5.1.4 Multiroom Mode

Multiroom mode means you have more than one room/area (several Controllers) and they are grouped together.

#### Notes:

1. All Controllers and/or Speakers must be connected to the same Wi-Fi network.
2. The speed of the network is very important to ensure the Multi-room mode. If more than two Controllers are grouped, we recommend the use of a 5GHz multimedia router.

To create a group, open the App and go to the “Select a Player” screen. Press the “Group” button on the room/area with which you want to create the group. Select from the list the rooms/areas you wish to group together and select done when finished. Once the group is created play your music.

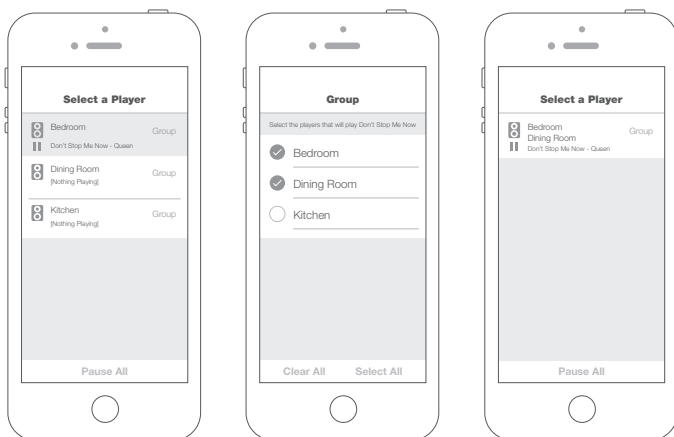

## 5.2 Bluetooth Mode

The In Wall Wi-Fi SOUNDAROUND Controller includes a Bluetooth Audio Receiver that can be connected to a Bluetooth compatible device (smartphone/tablet). Before commencing any pairing process we recommend that you check that your Bluetooth device has A2DP/AVRCP profiles. In addition, the pairing process can vary between manufacturers. Please read carefully your Bluetooth device user manual beforehand. For a successful pairing make sure the Bluetooth device is close to the Controller when performing this task.

To turn on the BLUETOOTH mode press the Bluetooth key for 4". Once the blue led flashes you are ready to pair. The Controller remains in pairing mode for one minute. If the Bluetooth device is not connected during this time, the Controller will automatically return to Wi-Fi mode and you must repeat the process.

Open the Bluetooth settings menu in your Bluetooth device (smartphone/tablet) and select the Controller's BLUETOOTH identifier (Same UNIQUE identifier previously set up for Wi-Fi mode). This is the moment to pair. This step will only be necessary the first time for each Bluetooth device.

Once the connection is established the blue led will stop flashing and remains ON while the Bluetooth device is being used and within range of coverage (approx.10 meters/33 feet).

Now simply connect and play your music. Your DEVICE will control directly all features such as choosing the song, play, pause, volume... not the JUKEBOX ALLPLAY App. The Controller will revert to the Wi-Fi mode when the Bluetooth is disconnected or out of range.

### 5.2.1. BLUETOOTH Re-streaming

Once your Bluetooth device is connected to the Controller you may take the advantage of the Wi-Fi network and RE-STREAM the Bluetooth signal (your music) to other rooms/ areas connected to the same Wi-Fi network. This is a UNIQUE feature of the In Wall Wi-Fi SOUNDAROUND Controller.

**IMPORTANT:**

1. For the correct performance of this feature we recommend you use a 5GHz multimedia router.
2. High traffic on the network (video streaming, downloading files, etc.) affects negatively the performance.
3. If a group has been created previously the Controller will automatically re-stream the Bluetooth signal to the same group. Check the ALLPLAY JUKEBOX App beforehand to see if such group exists.
4. If the user wish to re-stream the Bluetooth signal to a different group then a new group needs to be created (Multiroom mode) using the ALLPLAY JUKEBOX App before choosing the Bluetooth mode.

**5.3 AUDIO-IN Mode**

You can connect an external audio device to the AUDIO-IN 3.5mm jack input connector at the front of the Controller. The Controller will enter in AUDIO-IN mode automatically. The LED indicator will turn ON in red.

The AUDIO-IN audio source can also be selected in the ALLPLAY JUKEBOX App in your smartphone/tablet. Select the Controller - Input Mode - Line in.

Now simply play your music. Your EXTERNAL AUDIO DEVICE will control directly all features such as choosing the song, play, pause, volume... not the JUKEBOX ALLPLAY App.

Please note that the volume of the music in AUDIO-IN mode is the addition between the volume of the external audio device connected to the jack, and the volume of the controller (managed by the volume keys or the app). For the best result look for a balance between the volume on the external device and the Controller by adjusting both.

The controller will revert to the Wi-Fi mode when the AUDIO-IN is disconnected.

**Notes:**

1. *If you are not playing music using the AUDIO-IN jack input, do not leave the audio device or the jack cable connected to the Controller as this may give rise to noise interferences.*

**5.3.1 AUDIO-IN Re-streaming**

Once your external audio device is connected to the Controller you may take the advantage of the Wi-Fi network and RE-STREAM the AUDIO-IN signal (your music) to other rooms/ areas connected to the same network. This is a UNIQUE feature of the In Wall Wi-Fi SOUNDAROUND Controller.

**IMPORTANT:**

1. For the correct performance of this feature we recommend you use a 5GHz multimedia router.
2. High traffic on the network (video streaming, downloading files, etc.) affects negatively the performance.
3. If a group has been created previously the Controller will automatically re-stream the AUDIO-IN signal to the same group. Check the ALLPLAY JUKEBOX App beforehand to see if such group exists.
4. If the user wish to re-stream the AUDIO-IN signal to a different group then a new group needs to be created (Multiroom mode) using the ALLPLAY JUKEBOX App before choosing the AUDIO-IN mode.

## 6. Settings

In the settings menu, you can access different options, as follows:

### PLAYERS

When the user presses the “Player” information you will see all details relating to the Controller. This menu offers the following options:

#### **1. Player Name**

The user can customize the name of the Controller. If you change the name it is mandatory to update the Bluetooth pairing in your Bluetooth device. Delete the previous pairings and pair with the Controller again.

#### **2. Firmware update**

If you trigger the firmware update, the Controller will be inoperable for few minutes. Be sure the Controller is always powered on.

- If after the firmware update the Controller does not exit from the rebooting mode (all leds flash for more than 40”), press the WPS button on your Controller for 6” and then release it.
- After releasing, the factory default reset is done. Wait 40” until the rebooting mode ends. When the Wi-Fi is flashing in white the setup process should be done.
- Go to the App and repeat the firmware update process.

#### **3. Password**

The password is a security measure to avoid other users access and changing the setup parameters.

#### 4. Restart / Reset

Restart:

Press Ok and the restart process will commence. Wait 40" until the rebooting mode ends and the Wi-Fi led is ON in white. The restart DOES NOT clear the Controller setup (identifier and network connection setup).

**To activate manually** the RESTART: Press at the same time the VOLUME+, VOLUME- and MUTE key.

Reset to Factory Settings:

This will reset the Controller to its factory default settings. You will need to set up again the Controller to your Wi-Fi network. It will not reappear in the list of players until it has been set up again in your network. Press "Reset" and "OK". The Reset process will commence. Wait 40" until the rebooting mode ends and the Wi-Fi led is flashing in white and start the set up (see chapter 4).

**To activate manually** the RESET TO FACTORY SETTINGS: Press the WI-FI key for 8", the Controller enters in Rebooting mode.



## 7. FAQ's

<p><b>I can't associate my SOUNDAROUND Controller to my router</b></p>	<ol style="list-style-type: none"> <li>1. Please make sure the Controller is POWERED-ON and wait at least one minute to connect it to the router.</li> <li>2. Reset your device and try again.</li> <li>3. If the audio device was already associated to a Wi-Fi network and you want to connect it to another network, please reset the Controller to factory settings.</li> <li>4. Try to associate your audio device using the browser method or the WPS button method.</li> </ol>
<p><b>I can't find any/some Controllers in the ALLPLAY JUKEBOX App</b></p>	<ol style="list-style-type: none"> <li>1. Be sure that the smartphone/tablet AND the Controllers are connected to the same Wi-Fi network.</li> <li>2. Check that the Wi-Fi Led is ON in white. If the Led is flashing the Controller is not connected to the Wi-Fi network. Please review the set up.</li> <li>3. Make a restart (see chapter 6.4).</li> <li>4. Close the ALLPLAY JUKEBOX App. Be sure that the App is not in background mode and open it again.</li> </ol>
<p><b>A Controller does not react to the control from the ALLPLAY JUKEBOX app</b></p>	<p>Close the ALLPLAY JUKEBOX App. Be sure that the App is not in background mode and open it again. Sometimes the Controller needs time to react due to Wi-Fi traffic network conditions. Please, wait for a few minutes.</p>
<p><b>I can't play some songs</b></p>	<p>Be aware that the system does not support WMA format. Some music stores (i.e. Apple Store) contain restricted rights and cannot be played on external devices.</p>

<p><b>I can't play some Music Services</b></p>	<ol style="list-style-type: none"> <li>1. Be sure that the Music Service App (Spotify, Napster, etc) is updated to the latest release.</li> <li>2. Be careful with the requirements of the Music Services being streamed to a Wi-Fi audio system. E.g. Spotify requires a Premium account to be able to stream music via a Wi-Fi system.</li> </ol>
<p><b>I can't control the volume when using some Apps</b></p>	<p>Some Apps such as Spotify can interfere with the ALLPLAY JUKEBOX App volume control. Close the Spotify App and control the volume only from the ALLPLAY JUKEBOX App.</p>
<p><b>When streaming from the Music Services the music stops or jumps</b></p>	<p>Sometimes Music Services suffer cuts from the original source. Try to connect to another Music Service. If the problem persists try to play Music on the Device. If Music on the Device plays normally, the problem is with the Internet connection. Check the Internet speed reception.</p> <p>If the problem continues it could be the Wi-Fi network. Check the router and the installation advices given in chapter 4.</p>
<p><b>I can't pair my Bluetooth device with a Controller because I don't see the Controller in the list of devices in the smartphone/tablet</b></p>	<p>Make sure that the Controller is in pairing mode (take care that the max time is 1 minute). Remember that you need to activate it manually. Disconnect and re-connect Bluetooth in the smartphone/tablet.</p>
<p><b>It's not possible to connect through Bluetooth with a Controller which was previously paired</b></p>	<p>If the Controller has changed the identifier or any setup data, or the firmware has been updated, it is necessary to pair again.</p> <p>In the smartphone/tablet, delete the paired Controller.</p> <p>Pair again the Controller with the smartphone/tablet.</p>

<b>When Bluetooth is muted in the Controller with which it is connected are all the Controllers in the group muted?</b>	<p>If the Controller which is receiving the Bluetooth by streaming is muted, it will stop the re-streaming, so all the Controllers will be muted.</p> <p>If you press the mute key on one of the Controllers in the group independent of the one that is receiving the Bluetooth streaming only this Controller will be muted, it does not mute the rest of Controllers of the group.</p>
<b>Does the Controller support AirPlay or Google ChromeCast Audio?</b>	<p>Connect Airplay or Google Chromecast Audio to AUDIO-IN and choose it as audio source (see chapter 5.3). Then, you can manage the audio streamed by AirPlay or Google Chromecast Audio.</p>
<b>Mute key does not pause the track</b>	<p>Muting does not mean the audio is paused. The mute eliminates the volume but it does not stop nor pause the streaming.</p> <p>When the mute is activated the led flashes.</p> <p>If the Controller is grouped, the rest of Controllers will continue to listen to the music.</p>
<b>Audio quality is deficient</b>	<p>If audio-cuts are occurring mainly when re-streaming to other Controllers, it is advisable to use a 5G router rather than a 2,4G. It may be advisable at times to use an ETHERNET connection.</p> <p>Be aware that other equipment sharing the same network such as computers, TV's, smartphones... all compete for the same Wi-Fi band, which can lead to performance problems.</p>

## 8. Technical Specifications

60201	MIN	NORMAL	MAX		COMMENTS
Measurements		175x100x37		mm	exterior (width x height x depth)
		125x75x35		mm	cavity (width x height x depth)
Voltage	12		24	Vdc	terminal VCC - GND
Consumption demand VDC = 12Vdc			14	W	terminals L, R / 16 ohms
			18	W	terminals L, R / 8 ohms
			30	W	terminals L, R / 4 ohms
Consumption demand VDC = 15Vdc			18	W	terminals L, R / 16 ohms
			27	W	terminals L, R / 8 ohms
			45	W	terminals L, R / 4 ohms
Consumption demand VDC = 24Vdc			44	W	terminals L, R / 16 ohms
			60	W	terminals L, R / 8 ohms
Output signal VDC = 12Vdc			3,5+3,5	W	terminals L, R / 16 ohms
			6+6	W	terminals L, R / 8 ohms
			10+10	W	terminals L, R / 4 ohms
Output signal VDC = 15Vdc			5,5+5,5	W	terminals L, R / 16 ohms
			10+10	W	terminals L, R / 8 ohms
			16+16	W	terminals L, R / 4 ohms
Output signal VDC = 24Vdc			15+15	W	terminals L, R / 16 ohms
			25+25	W	terminals L, R / 8 ohms
Audio In signal		775	1000	mVrms	jack 3,5mm
Wifi transceiver		2,4/5		GHz	
Ethernet/LAN	yes				
App support	IOS 7.0 / ANDROID 4.1				minimum versions
Wi-Fi connected	WPS / Webpage				
Antena RF	internal				
Multiroom max units in the same network		5	10		Router 1200Mbps / 5GHz band
Bluetooth	BT 4.0 A2DP 1.3 (Sink) AVRCP 1.5 (Controller&Target)				



#### **EU Declaration of Conformity (DoC)**

Hereby Electrónica Integral de Sonido S.A., Pol. Malpica G.Quejido 87-88 , 50016 Zaragoza (Spain) declares that this product is in compliance with the provisions of the EC directives 2004/108/EC, 2014/35/EU, 1999/5/EC, 2011/65/EU meeting the following conformance standards IEC 60065, EN 55013, EN 55020, EN 61000-3-2, EN 61000-3-3, EN 300328 v1.8.1, EN 301893 v1.7.1, EN 301489-1, EN 301489-17, EN 50564.





## eissound

Pol. Malpica - Grupo Quejido 87-88  
50016 Zaragoza - SPAIN  
Tel. +34 976 46 55 50 Fax +34 976 46 55 59  
marketing@eissound.com  
**www.eissound.com**

## KBSOUND

245 Riverside Av. Suite 150  
Jacksonville, FL 32202 (USA)  
info@kbsound.com  
**www.kbsound.com**

