



A T C E l e c t r o n i c s

U s e r O p e r a t i n g M a n u a l



1. **Read instructions** – all the safety and operating instructions should be read before the appliance is operated.
2. **Retain these instructions** – the safety and operating instructions should be retained for future reference.
3. **Heed warnings** – all warnings on the appliance and in the operating instructions should be adhered to.
4. **Follow instructions** – all operating and other instructions should be followed.
5. **Water and moisture** – the appliance should not be used near water, for example near a bathtub, washbowl, kitchen sink, laundry tub, in a wet basement or near a swimming pool etc..
6. **Ventilation** – the appliance should be situated so that its location or position does not interfere with its proper ventilation. For example, the appliance should not be situated on a bed, sofa, rug or similar surface that may block the ventilation openings. Similarly, the appliance should not be built into an installation, such as a bookcase or cabinet, that may impede the flow of air through the ventilation openings.
7. **Heat** – the appliance should be situated away from heat sources such as radiators, stoves or other appliances that produce heat.
8. **Power sources** – the appliance should be connected to a power supply only of the type described in the operating instructions or as marked on the appliance.
9. **Power cord protection** – power supply cords should be routed so that they are not likely to be walked on or pinched by items placed upon or against them, paying particular attention to cords at plugs, convenience receptacles and the point where they exit the appliance.
10. **Cleaning** – the appliance should be cleaned only as recommended by the manufacturer.
11. **Unattended periods** – the power cord of the appliance should be unplugged from the outlet when left unused for a long period of time.
12. **Object and liquid entry** – care should be taken so that objects and liquids do not fall into the appliance.
13. **Damage requiring service** – the appliance should be serviced by qualified service personnel when:
 - i. the power supply cord or the plug has been damaged
 - ii. objects have fallen or liquid has been spilled into the appliance
 - iii. the appliance has been exposed to rain or other serious liquid exposure
 - iv. the appliance does not appear to operate normally or exhibits a marked change in performance
 - v. the appliance has been dropped or the cabinet damaged
14. **Servicing** – the user should not attempt to service the appliance beyond those measures described in the operating instructions. All other servicing should be referred to qualified service personnel.
15. **Grounding or polarisation** – precautions should be taken so that grounding or polarisation means for the appliance are not defeated.

Contents

Page 1		Introduction
Page 1	Generic Information	
	Section G1	Installation
	Section G2	Mains Connection
Page 2	Section G3	Fuses
	Section G4	ATC Remote Handset
	Section G5	Care and Maintenance
	Section G6	Warranty and Contact
Page 3	CA2 Preamplifier	
	Section 1.1	Description
	Section 1.2	Inputs
Page 5	Section 1.3	Outputs
	Section 1.4	Operation
Page 6	Section 1.5	Specifications
Page 7	SCA2 Preamplifier	
	Section 2.1	Description
	Section 2.2	Inputs
Page 9	Section 2.3	Outputs
Page 10	Section 2.4	Operation
Page 11	Section 2.5	Specifications
Page 12	P1 & P2 Power Amplifiers	
	Section 3.1	Description
	Section 3.2	Inputs
	Section 3.3	Outputs
Page 13	Section 3.4	Operation
Page 14	Section 3.5	Specification
Page 15	SIA2-150 Integrated Amplifier	
	Section 4.1	Description
	Section 4.2	Inputs
	Section 4.3	Outputs
Page 16	Section 4.4	Operation
Page 17	Section 3.5	Specification

Introduction

Welcome. In selecting ATC you have chosen an example of the finest audio engineering available. ATC was founded on a principle of engineering excellence, and that principle still defines our products today. Given the right opportunities, ATC products will deliver exceptional audio performance, but the opportunities will only arise from careful and thoughtful installation and use. Please read the following manual fully. It will help you understand the product and to realise its full potential. We are happy to answer questions and offer advice on any issues that arise through installation or use of ATC products. Contact details can be found at the back of this manual.

ATC was founded in London in 1974 by Australian emigre Bill Woodman, who still heads the company today. An enthusiastic pianist and engineer he was naturally drawn to loudspeaker design and after a period working at Goodmans, where many of the names that went on to found British loudspeaker companies began their careers, he struck out on his own. The premise on which ATC began is a simple one, and one that in many respects is still true today: hi-fi loudspeakers tend to be detailed and accurate but of limited dynamic range, while professional monitor speakers tend to express the opposite character. ATC products were designed from the outset to offer the best of both. It's an easy concept to describe, but surprisingly difficult to engineer.

The difficulty inherent in designing such loudspeakers is one of scale. Hi-fi levels of accuracy and detail call for lightweight moving parts and delicate engineering. Professional monitor levels of performance however demand far more robust components engineered to survive the rigours of high level use for extended periods. The only way to combine the two is through precision engineering of a class and scale more often associated with aerospace or motor-sport. But the results are worth the effort and the cost. ATC loudspeakers, with their unique in-house designed drivers, combine the best of hi-fi and professional to devastating effect.

ATC has become synonymous with active systems. Choosing to offer active loudspeakers (where the passive crossover network is replaced by active filters and multiple power amplifiers) is simply a result of the uncompromising attitude to loudspeaker design. While passive systems still have their place, and ATC engineering skills can still bring remarkable results from them, "active" is a fundamentally better solution to the problems posed by accurate, high level music reproduction. The ATC instinct is always for the better solution. Not cheaper, not quicker, but better.

It was the development of active loudspeakers that first brought ATC into electronics design and engineering. Active speakers demand multiple power amplifiers so ATC from the mid 1980s became not just a loudspeaker manufacturing company but an electronics manufacturer too. The further step from electronics for active speakers to a range of stand-alone amplifier products was natural and now means that ATC engineering is available from the recording desk or CD player output to the ears.

From modest beginnings ATC has grown to become one of the very few manufacturers successful across both domestic and professional audio. By selecting ATC you join a group of music lovers, professional audio engineers, studios and musicians across the World that understand and value the engineering that goes into an ATC product - and the sound that comes out.

Generic Information

The information in the following Sections G1 to G5 is common to all ATC electronics products. We recommend that you read this page, and the safety warnings that proceed it, before continuing to read the pages dedicated to your specific ATC products.

G1 Installation

ATC Equipment has been designed to be free standing either within an equipment stand or simply on a convenient item of furniture. There are no special ventilation requirements (but please see notes on Amplifiers below). It is recommended that at least 100mm (4 inches) clearance be left behind a unit for plugs and cables.

ATC Equipment has been designed to remain powered-up in Standby mode unless it is to be unused for a long period of time. Power dissipation will make the unit warm to the touch in either standby or operational mode. Temperature stability will be reached after approximately three hours from mains switch-on. Full audio performance is available immediately.

ATC Preamplifiers should be located as close to the source components as practically possible to minimise the cable length. The Outputs however are capable of driving up to 50 metres of good quality cable; therefore it is practical to locate the Preamplifier a distance away from the monitor or Power Amplifier(s).

ATC Power Amplifiers should ideally be located to minimise the cable lengths from both the source components and the Loudspeakers. Use of loudspeaker cables in excess of 20 metres should be avoided if possible to prevent a possible degradation in sound quality. Care must be taken to ensure that ventilation holes in the top and bottom covers are not obscured. Please contact ATC if the Amplifier is to be mounted in an enclosed area.

G2 Mains Connection

The CA2 and SCA2 Preamplifiers can be used with mains voltages from 100V to 240V, 50/60Hz. Please ensure that the local mains voltage matches that uppermost on the rear panel voltage selector plate before applying mains power to the unit. The mains voltage selection can be adjusted by lifting the selector plate marked with four legends (100, 120,

220, 230) with a small screwdriver and re-inserting the plate with the correct voltage uppermost.

The SIA2-150 can be used with mains voltages from 100V to 240V, 50/60Hz, when set accordingly.

The P1 and P2 can be used with mains voltages from 115V to 240V, 50/60Hz, when set accordingly.

Mains voltage is factory set and should only be adjusted by ATC or your local dealer or distributor. Please ensure that the local mains voltage matches that specified on the rear panel before applying power to the SIA2-150, P1 or P2.

The mains cable has been specifically supplied to comply with local statutory safety approvals and alternatives should not be substituted. If you intend to use your unit in an alternative territory, please contact ATC for advice.

ATC equipment MUST be earthed. Do not remove the earth wire in the mains plug.

G3 Fuses

Mains power supply fuses are fitted within the CA2 and SCA2, but they are not intended to be user replaceable.

The mains power supply fuse for the SIA2-150, P1 and P2 Amplifiers is located on the rear panel. Should the Amplifier fail to switch on when the power switch is operated, the fuse should be inspected. PLEASE ENSURE THAT THE UNIT IS DISCONNECTED FROM THE MAINS SUPPLY BEFORE INSPECTING OR REPLACING A FUSE. Lift out the fuse holder cover using a small screwdriver, remove the fuse and inspect it for damage. Fuses most often fail due to a serious electrical fault. Only replace fuses with the same type as that suspected to be blown. All fuses are 20mm "Type T anti surge". The fuse rating is printed on the rear panel adjacent to the fuse. If a replacement fuse also fails then the Amplifier should be returned to ATC for service.

G4 ATC Remote Handsets

The SCA2 is supplied with an SCA R remote handset. Provided that the SCA2 is connected to the mains power and its rear panel power switch is on, the SCA R provides for remote operation of all the SCA2 functions. The SCA R also includes

a standard set of CD Player commands, which may be used to control any CD or DVD/SACD Player that supports the standard RC5 control code set.

Use the handset On/Reset button to switch the SCA2 into active mode and the Standby button to return the SCA2 to Standby mode. Monitor and Record selection can be made by pressing the desired monitor or record button. The SCA2 front panel source indicators will illuminate but the rotary controls will not rotate.

Volume is controlled through the handset Level + and – buttons. The SCA2 front panel Level control will rotate in response to handset level commands. The handset Attn button is equivalent to the front panel Gain function. The handset Mute function operates in exactly the same way as the front panel control.

The red indicator on the handset will flash as functions are operated. Failure of this indicator points to exhaustion of the handset battery. The battery should be replaced, and the old battery disposed of, by your local dealer or distributor.

The CA2, SIA2-150, P1 and P2 are supplied with the ATC remote handset. This provides for remote operation of all functions of the units, and includes a standard set of CD Player commands that may be used to control any CD or DVD/SACD player that supports the RC5 control set. Power is supplied by 2 X AAA batteries (included).

Reliable operation of the remote handsets require direct line of sight between the handset and the unit front panel. Correct operation of the handset on the SCA2 is indicated by illumination of a red indicator on the left hand side of the front panel as handset commands are received.

G5 Care and Maintenance

ATC use high technology material finishes in all of their products. The surfaces are durable and with a little care can be kept as good as new even under conditions of heavy use. Normally a dry duster is all that is required to keep the finishes clean. Heavy soiling can be cleaned using a slightly moistened cloth with a non-abrasive household cleaner.

G6 Warranty and Contact

All ATC products are guaranteed against any defect in materials or workmanship for a period of two years from the date of purchase. Within this period we will supply replacement parts free of charge provided that the failure was not caused by misuse, accident or negligence.

Purchasers who complete and return the Warranty Card will have their warranty period extended up to a period of six years from the date of purchase. This guarantee does not limit your statutory rights. ATC can be contacted at:

Loudspeaker Technology Ltd.
Gypsy Lane, Aston Down,
Stroud, Gloucestershire. GL6 8HR UK
Telephone: 01285 760561
Fax: 01285 760683
Email: info@atc.gb.net
Web: www.atcloudspeakers.co.uk

1.1 Description

The CA2 preamplifier has been designed to partner ATC active, and with an appropriate power amplifier, passive loudspeaker systems. It incorporates 4 line-level stereo inputs, a high sensitivity phono amplifier input, and a tape monitor input on RCA phono sockets. One stereo record output, a main stereo output and a sub output on RCA phono sockets, together with a main stereo output on XLR sockets and a headphone output on a 1/4" jack socket.

The phono amplifier stage carries an array of slide switches that enable optimal matching to phono cartridges of various output voltages and load requirements.

Selection of CA2 inputs is achieved via a five position rotary control using gold plated relays for silent switching. Output volume adjustment is achieved through a precision motorized potentiometer. The tape monitor function can be selected from a front panel push button. The tape output is a duplicate of the source selected by the input selector. Standby is also accessible from a front panel push button. Mains power is applied from a rear panel mounted switch.

All CA2 functions are duplicated on the ATC remote handset.

1.2 Inputs

The CA2 accepts unbalanced RCA phono style input plugs. The signal is present on the centre conductor of an unbalanced input and the signal return is made via the screened outer. If there is any hum present on the output this must be traced to its source and not suppressed by the removal of screens and earths. Removal of the screen on an unbalanced input will result in uncontrollably loud hum. The input sockets are illustrated in Diagram 1.

Inputs labeled CD, TUNER, AV and AUX1 are at line sensitivity and are electrically identical. A line-level signal from any source equipment may be connected to any of these inputs.

The right-hand (viewed from the rear) pair of AUX2/PHONO input sockets function as a high sensitivity phono input. All inputs are via RCA phono connectors.

Diagram 1 - CA2 rear panel and connection sockets

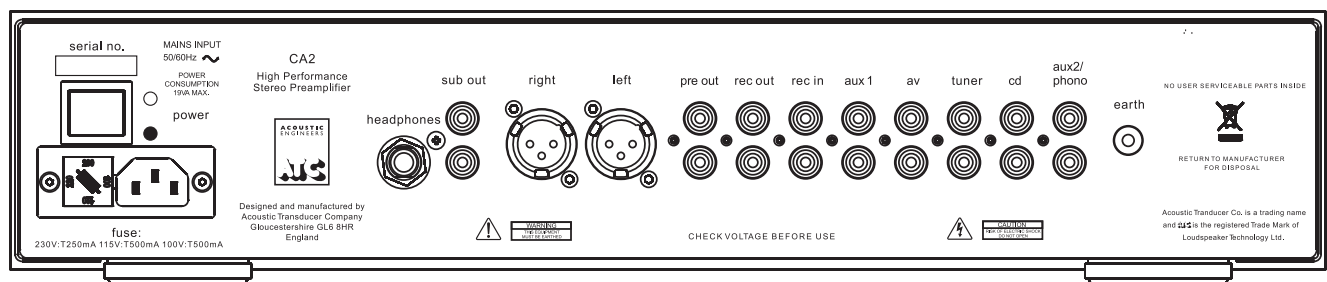

The phono amplifier can be configured to accommodate a wide selection of phono cartridge types by setting combinations of the board mounted jumpers (links). Access to the phono stage is gained by removing the cover of the preamplifier. Diagram 2 illustrates the position of the jumpers on the board while Table A details the cartridge matching options available.

Pulling them gently away from the board with a small pair of pliers and replaced in the appropriate positions as shown in the diagram moves links. Unused links can be “parked” on the board by setting them at right angles on unused pins.

Jumpers J2 and J5 set the input load for each channel of the cartridge. With the jumper in place the load is 100 ohms. With the jumpers removed the load is 47k ohms.

Jumpers J3, J6, J1 and J4 set the gain (sensitivity) of the phono input. J3 and J6 have two positions A and B. In position A the gain of the phono stage is reduced, in position B the gain is increased. J1 and J4 can have the jumper fitted or removed. When fitted the gain of the circuit is increased. By setting combinations of these 4 jumpers, a range of sensitivities can be accommodated.

For example: for a cartridge with a low sensitivity J3 and J6 would be set in position B while J1 and J4 would both have their jumper fitted. Table A illustrates the input sensitivity and load characteristics available. The manufacturer of the cartridge in use will be able to recommend the appropriate settings.

Diagram 2 - RIAA Phono Board and Jumpers

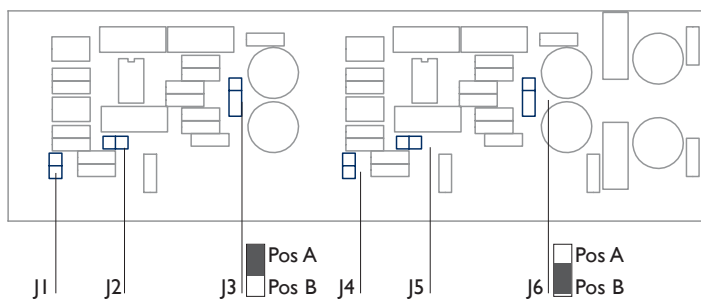

Table A - RIAA Jumper Settings

Jumper settings for 1 Volt Output			
Sensitivity	J1 and J4	J2 and J5	J3 and J6
10.0mV	Removed	Fitted (100Ω)	Position A
6.7mV	Removed	Removed (47kΩ)	Position A
5.1mV	Removed	Fitted (100Ω)	Position B
3.4mV	Removed	Removed (47kΩ)	Position B
2.2mV	Fitted	Fitted (100)	Position A
1.4mV	Fitted	Removed (47kΩ)	Position A
1.1mV	Fitted	Fitted (100Ω)	Position B
0.7mV	Fitted	Removed (47kΩ)	Position B

1.3 Outputs

The CA2 rear panel illustrated in Diagram 1 carries sockets for main left and right output, tape left and right output, left and right summed mono output and an output for stereo headphones. Use of the headphone jack will mute the output from the main stereo output and also the sub output.

Connections to the main output may be from RCA phono plugs or XLR plugs. Connections to the XLR output sockets follow the convention of pin 1 to ground, pin 2 to signal “hot” and pin 3 to signal return (signal ground). When connecting to equipment with XLR (balanced) inputs, the connectors should be wired pin for pin (i.e. 1 to 1, 2 to 2, and 3 to 3). Diagram 3 illustrates the XLR output pin arrangement. Diagram 4 illustrates the cable arrangement for connection to balanced inputs.

Cables up to 50 metres in length may be connected to the main stereo or sub outputs.

1.4 Operation

Once connected to mains power and powered up from the rear panel mains switch, the front panel Standby button (or remote handset Standby button) will switch the CA2 between standby and active mode. In Standby mode the Standby Indicator glows RED. Operating the Standby function from either the front panel or the remote handset will switch the CA2 into active mode. The RED indicator will extinguish and be replaced by the Input select indicator showing the current selection in GREEN. Operating the Standby function again will return the CA2 to Standby mode.

Inputs are selected by rotating the input select control in either direction. The control has continuous movement. When it is moved to the last input, further rotation will select the first input.

A separate tape loop is included with a Monitor option selected by a single push button on the front panel. The tape output will have the same signal as selected by the rotary input select control. Operation of the Standby or tape monitor controls will not affect this output providing mains power is maintained.

Diagram 3 - output socket pins

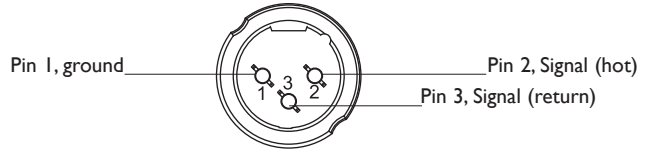

Diagram 4 - balanced cable

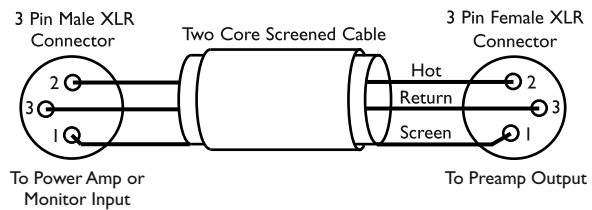
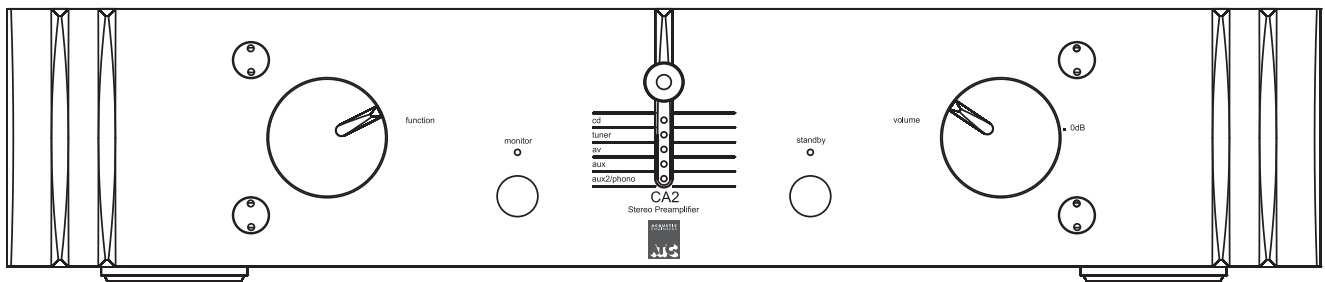

Diagram 6 - CA2 front panel and controls



Output level is controlled by the rotary Volume control on the front of the unit, the position of which is indicated by a black pointer. Rotating the control clockwise will increase the output level. It is good practice to lower the volume setting before switching on the preamplifier or any associated equipment, or while changing the input selection.

Unity gain through the CA2 from any of the line level inputs is indicated by the '0dB' print on the front panel, beside the volume control. This is the volume position the preamp should be set to for 'Home Cinema Bypass' so the CA2 has no influence on signal level when used within a cinema surround system.

Due to the nature of the electronics in ATC amplifiers it is quite normal for a sound to be heard from the speaker when the power is applied or disconnected. The noise heard will not damage the speaker and is quite normal. Although ATC uses the highest-grade components, a different noise may be heard from each speaker due to slight tolerance variations in the amplifier components.

1.5 Specifications

Maximum Output Level	7.5V RMS into 600 Ohms
Line Input Sensitivity (for IV Output):	150mV
R.I.A.A. Input sensitivity:	See Table A
R.I.A.A. Input Impedance:	See Table A
R.I.A.A. Accuracy (20Hz – 20kHz):	±0.5dB
Input Impedance:	5k Ohms
Output Impedance:	10 Ohms
Frequency Response (-3dB):	DC – >500kHz
Total Harmonic Distortion:	<0.0005% (-106dB) 1V into 600 Ohms
Crosstalk (10Hz – 20kHz)	>90dB
S+N/N Ratio:	>95dB (Wide band) >104dB (DIN) >108dB (IEC "A")
Power Requirements	100, 115, 230V, 50/60Hz
Power Consumption	35VA Maximum
Dimensions (including terminals)	H90 x W445 x D330mm H3.54 x W17.5 x D13.0 inches
Weight	7kg (15.4lb) Net 8kg (17.6lb) Packed

E. & O.E. The policy of Loudspeaker Technology Ltd. is that of continuous design and development. We reserve the right to change specifications without prior notice.

2.1 Description

The SCA2 is an extremely high resolution preamplifier designed to partner ATC active, and, with an appropriate power amplifier, passive loudspeaker systems. It incorporates eight line-level stereo inputs, two stereo signal outputs and two stereo record outputs. Two of the line inputs are balanced format on XLR sockets while the remaining inputs are unbalanced and on pairs of RCA phono sockets. The main stereo output is balanced format on a pair of XLR sockets while the auxiliary stereo output is unbalanced and on a pair of RCA phono sockets. The two record outputs are unbalanced on pairs of RCA phono sockets.

The AUX 2 line-level input may be converted to function as a high-sensitivity phono input through the addition of a factory fitted optional RIAA Phono Board. The RIAA board carries an array of slide switches that enable optimal matching with phono cartridges of various output voltages and loading requirements.

Selection of SCA2 inputs is achieved via a eight-position rotary control using gold plated relays for silent switching. The SCA2 incorporates an independent record output signal path so enabling simultaneous listening and recording of different source signals. Selection of the record output signal is achieved via a second eight-position rotary control using gold plated relays for silent switching.

Output volume adjustment is achieved through a precision motorised potentiometer. Mute, gain and standby functions are also accessible from front panel push buttons. Mains power is applied from a rear panel mounted switch.

All SCA2 functions are duplicated on the ATC SCA R remote control handset.

2.2 Inputs

The SCA2 can accept two balanced XLR inputs and six unbalanced RCA phono style inputs (2 as part of tape record/listen sets). The rear panel and input sockets are illustrated in Diagram 1. The input types and their identifying legends are illustrated in following Table A.

The AUX 2 input sockets will function as a high-sensitivity phono input if the optional SPH2 RIAA Vinyl Board is installed. The RIAA circuitry can be configured to accommodate a wide selection of phono cartridge types by setting combinations of board mounted links. Access to the board is gained by removing the top panel of the preamplifier. Diagram 2 illustrates the position of the links on the board while Diagram 3 and Table B detail the cartridge gain and input matching options available.

Links are moved by pulling them gently away from the board with a small pair of pliers and are replaced in the appropriate positions as shown in the diagrams. Unused links can be “parked” on the board by setting them at right angles on unused pins.

The SPH2 board is split into two identical channels. For the sake of clarity on the diagrams, the settings for only one channel are shown. Settings for one channel should be duplicated on the other. The cartridge gain and matching options should be used as described on the following page.

Diagram 1 - SCA2 rear panel and connection sockets

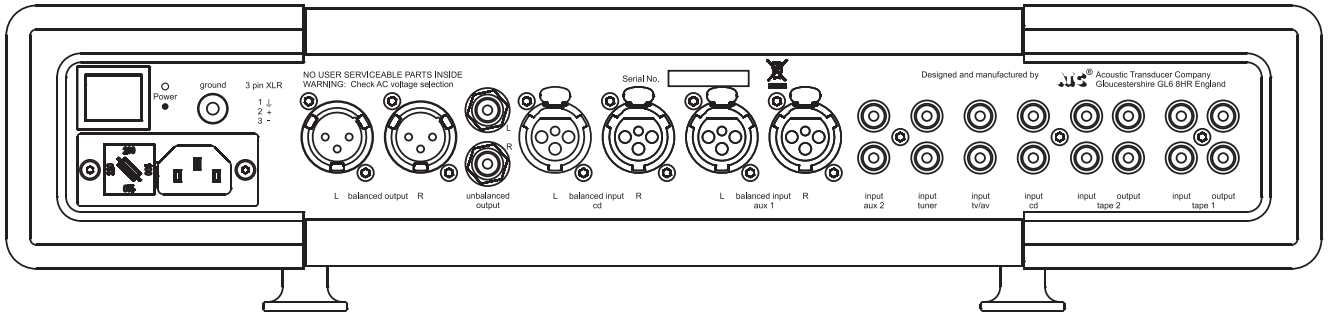

Table A - Input Sockets

Input socket types and legends

Rear Panel Legend	Front Panel Legend	Input Type	Notes
balanced input cd	cd bal	XLR balanced x 2	
balanced input aux 1	aux 1	XLR balanced x 2	
input aux 2	aux 2	RCA phono x 2	Marked "phono" on rear if SPH2 RIAA board fitted
input tuner	tuner	RCA phono x 2	
input tv/av	a/v	RCA phono x 2	
input cd	cd	RCA phono x 2	
input tape 2	tape 2	RCA phono x 2	Part of record/listen set
input tape 1	tape 1	RCA phono x 2	Part of record/listen set

Diagram 2 - SPH2 Board and Link Locations

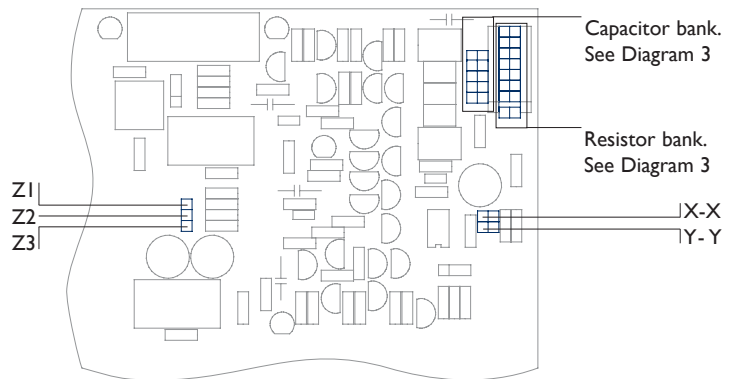

Diagram 3 - SPH2 Load Capacitor and Resistor Options

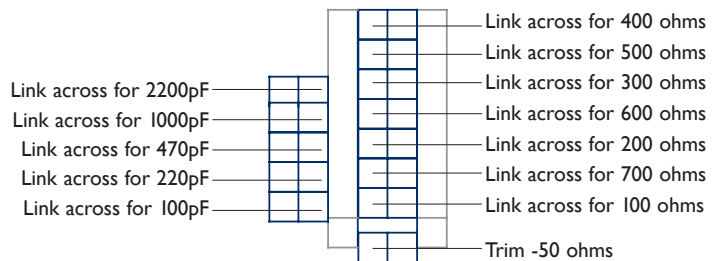

Table B - RIAA Board Gain Stage Link Setting

Mid point gain stage set LOW (11dB)			Link Z1 to Z2
First gain stage settings.			
Gain Setting	Gain mV	Gain dB	Link Position
High	1.14mV	59dB	Link both Y-Y and X-X
High/mid	1.6mV	55dB	Link Y-Y only
Mid	3.3mV	49dB	Link X-X only
Low	33.0mV	30dB	No links

Mid point gain stage set HIGH (24dB)			Link Z2 to Z3
First gain stage settings.			
Gain Setting	Gain mV	Gain dB	Link Position
High	0.25mV	71dB	Link both Y-Y and X-X
High/mid	0.38mV	68dB	Link Y-Y only
Mid	0.78mV	62dB	Link X-X only
Low	7.5mV	42dB	No links

Gain: Gain is set by fitting the Z link in one of two positions (Z1 to Z2 or Z2 to Z3) and by setting a combination of X and Y links. These links should be fitted according to the desired input sensitivities specified in Table B.

Capacitive Load: Capacitive load is set by selecting a link for the appropriate capacitance value as illustrated in Diagram 3. Multiple links may be used, in which case the load value is the sum of the selected values. For example, links in the 470pF position and 1000pF position give a total load value of 1470pF.

Resistive Load: Resistive load is set by selecting a link for the appropriate capacitance value as illustrated in Diagram 3. If no link is selected the default resistive load is 47 kilohms - appropriate for the majority of moving-magnet cartridges. A link in the -50 position will reduce any selected load by 50 ohms. For example, links in the 200 position and -50 position give a total load value of 150 .

Cartridge suppliers and manufacturers will be able to provide details of the loading and gain settings appropriate to their products. On some occasions there will be no specific recommendation for the capacitive load on moving-coil cartridges. In these cases it is best to assume no capacitance need be selected (no links used).

The rear panel ground terminal should be used to connect the pick-up arm earth lead.

2.3 Outputs

The SCA2 rear panel, illustrated in Diagram 1, carries sockets for balanced main left and right output, unbalanced main left and right output, and two unbalanced tape record outputs.

Choice between the balanced and unbalanced main outputs will depend on the input capabilities of the following power

amplifier (or active speakers). Use the balanced option in preference if both options are possible.

Connections to the primary output XLR sockets follow the convention of pin 1 to ground, pin 2 to signal “hot” and pin 3 to signal return (signal ground). When connecting to equipment with XLR (balanced) inputs the connectors should be wired pin for pin (ie. 1 to 1, 2 to 2 and 3 to 3). Diagram 4 illustrates the XLR output pin arrangement and Diagram 5 the connection scheme for a balanced XLR - XLR cable.

The unbalanced main left and right outputs and the tape record outputs should be connected using good quality RCA phono terminated leads. Use of the front panel volume, mute, or gain functions does not effect the tape record signal.

Cables up to 50 metres in length may be connected to the main outputs. Tape record cables should be limited to 10 metres.

Diagram 4 - balanced output socket pins

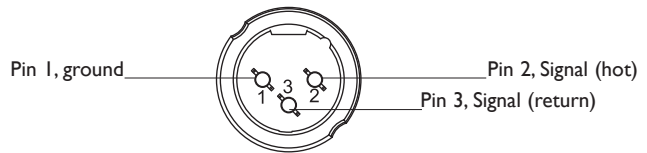

Diagram 5 - balanced cable pin connections

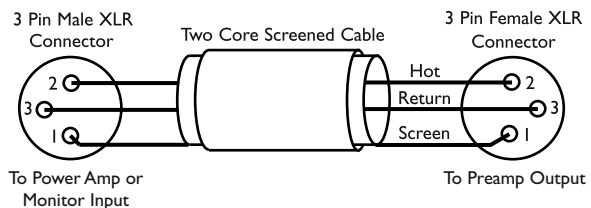
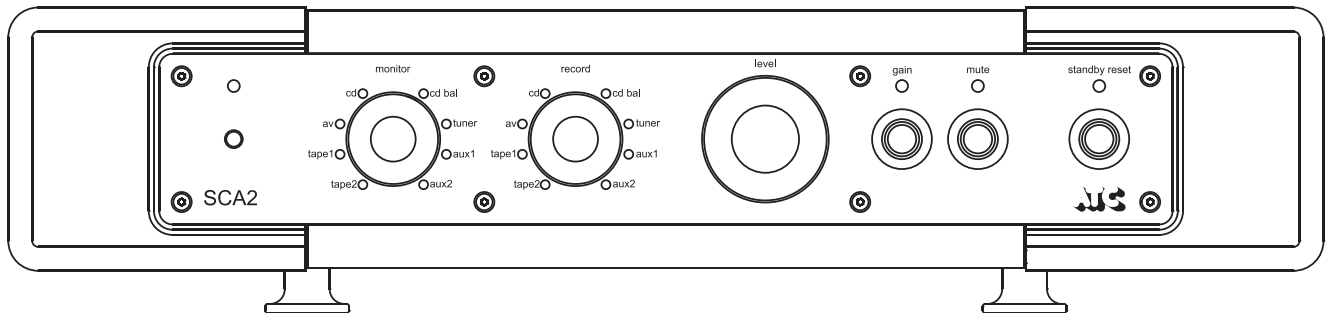

Diagram 6 - SCA2 front panel and controls



2.4 Operation

Once connected to mains power and powered-up from the rear panel mains switch, the front panel **Standby Reset** button (or remote handset Standby button) will switch the SCA2 between standby and active modes. In standby mode the Standby Reset indicator will illuminate. Operating the Standby Reset function will switch the SCA2 into active mute mode. The Standby Reset indicator will extinguish and the Mute indicator will illuminate. The **Mute** function automatically engages when the SCA2 is switched from standby to active mode. This precautionary feature provides an opportunity for the volume and input settings to be checked before audio is passed to the power amplifiers.

If all is well, the SCA2 may be brought into full operation by pressing the Mute function. The Mute indicator will extinguish. The Mute function can be used at any time to silence the system.

Inputs are selected by rotating the **Monitor** select control. The green indicator next to each monitor option will illuminate to indicate selection. The control has continuous movement. When it is moved to the last input, further rotation will select the first input.

Volume level is adjusted by rotating the **Level** control. A red indicator on the control indicates the level selected.

Volume level can be reduced immediately by 12dB by operating the **Gain** function. The Gain indicator illuminates to indicate its use.

Optimum sound quality will be achieved when the SCA2 has reached normal operating temperature and for this reason it is recommended that it be left in standby mode when not in use. It is a wise precaution however to switch-off the SCA2 from the rear panel power switch if it is to be left unused for an extended period.

The **Record** select control selects the input source routed to the tape outputs. The green indicator next to each record option will illuminate to indicate selection. The control has continuous movement. When it is moved to the last input, further rotation will select the first input. The source selected is made available at the tape output sockets and is fully buffered to prevent signal interaction. The Level, Gain and Mute functions have no effect on the record output signals.

Tape copying can be performed by selecting Tape 1 on the Record control to copy from Tape 1 to Tape 2. In this case no signal will be routed to the Tape 1 output sockets. Copying from Tape 2 to Tape 1 can be achieved in a similar manner.

Selecting Tape 1 on the Monitor control while also recording to Tape 1 (i.e. tape 1 is also selected on the record control) enables the off-tape signal from a three head tape machine to be monitored. The Tape 2 circuit works in an identical manner.

Due to the nature of the electronics in ATC amplifiers it is quite normal for a sound to be heard from the speaker when the power is applied or disconnected. The noise heard will not damage the speaker and is quite normal. Although ATC uses the highest-grade components, a different noise may be heard from each speaker due to slight tolerance variations in the amplifier components.

2.5 Specifications

MAIN OUTPUTS	
Maximum Output Level	8.5V RMS into 600 Ohms balanced 17.5V RMS into 600 Ohms unbalanced
Input Sensitivity (for IV Output)	230mV
Input Impedance	Phono (Unbalanced) 20k Ohms XLR (Balanced) 2k7 Ohms per leg
Output Impedance	10 Ohms
Frequency Response (-3dB)	DC - 500kHz
Total Harmonic Distortion	0.0005% (-106dB) @ 1V into 600 Ohms
Crosstalk (10Hz – 20kHz)	>90dB
S+N/N Ratio:	>95dB (Wide band) >104dB (DIN) >108dB (IEC "A")
Residual noise	>116dB (IEC "A")
Absolute phase	Phono (Unbalanced) Zero Degress XLR (Balanced) Zero Degrees, Pin 2 Hot
XLR CMRR (100Hz – 10kHz)	>90dB
Power Requirements	100V, 120, 220, 230V 50/60Hz
Power Consumption	35VA maximum
Dimensions (including terminals)	H100 x W440 x D360mm H3.9 x W17.3 x D14.2 inches
Weight	9.5kg (20.9lb) Net 11.0kg (24.2lb) Packed

E. & O.E. The policy of Loudspeaker Technology Ltd. is that of continuous design and development. We reserve the right to change specifications without prior notice.

3.1 Description

The P1 and P2 are high quality power amplifiers designed to partner ATC passive monitors and other loudspeaker systems. The amplifiers incorporate the same gain reduction and loudspeaker protection circuits as used in the ATC active monitors. This ensures that even when working at very high levels the amplifier is held back from clipping, so improving the subjective performance and protecting the loudspeakers from damage.

Both the P1 and P2 are of a "true" Dual Mono design, in that the power supplies signal and return paths are totally separated from each other. This approach ensures that the Amplifier will achieve the maximum signal separation and minimum crosstalk. Further, intermodulation between channels via the power supplies is reduced to an absolute minimum at all frequencies, and, the power delivery from one channel cannot affect the specified power available from the other channel.

The amplifier mains power is turned on by a switch on the rear panel. There is a Green L.E.D. on the front panel to indicate that the mains supply is connected, together with a Red L.E.D. to indicate that the Amplifier is in Standby. The Amplifier can be brought out of Standby by the Standby button on the ATC remote control (supplied with P1 and P2). On the rear panel there is a push button to defeat remote control operation in which case, when the Amplifier is switched on the unit will not be in Standby, The Red L.E.D. will be off, and the remote control has no effect.

3.2 Inputs

Single ended Inputs via RCA phono sockets, and Differential (balanced) Inputs via XLR sockets are provided. Each channel has two phono Input sockets, the "Link" Input phono sockets may be used to connect the Amplifier Inputs to a further ATC Power Amplifier for Instance as a Sub Channel.

3.3 Outputs

Loudspeaker connections are made using the two pairs of proprietary ATC loudspeaker terminals. The left and right channels are clearly marked and correspond to the left and right inputs. The positive terminal is marked red and the negative terminal is marked black.

Diagram 1 - P1 rear panel and connection sockets

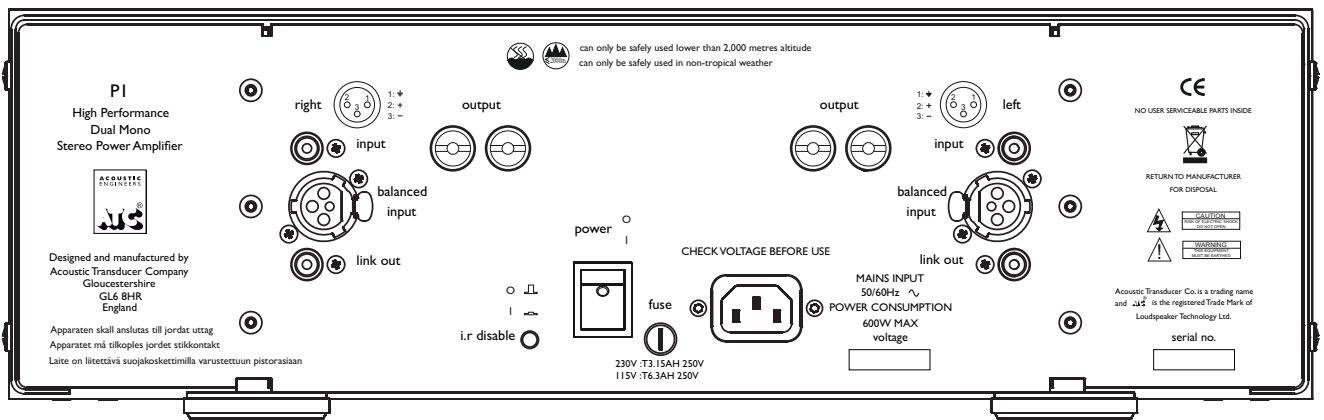
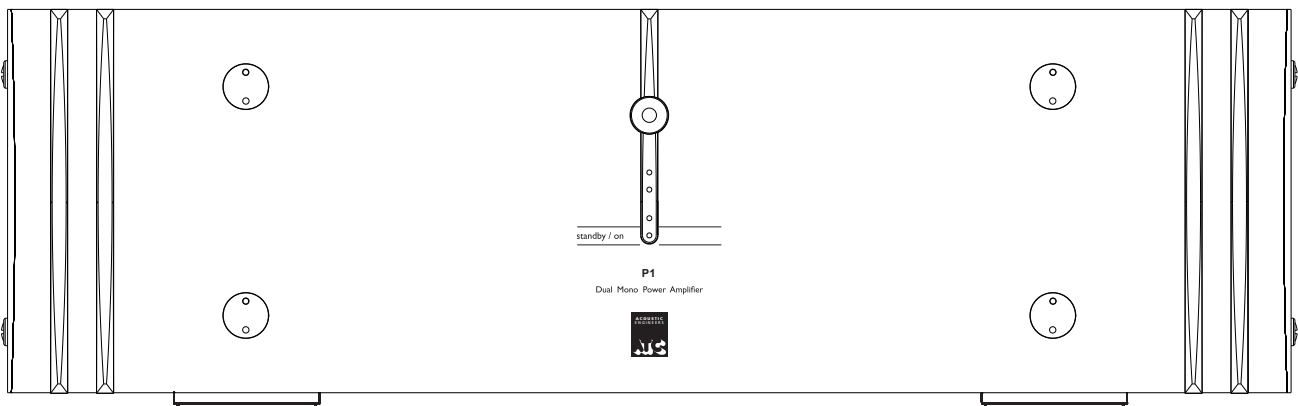

Diagram 2 - P1 front panel



3.4 Operation

A push button on the rear panel marked “i.r disable” defines how the amplifier will operate once connected to mains power and powered-up from the rear panel mains switch.

If the push button is “in”, the amplifier will power- up in “active” mode indicated by a GREEN light on the front panel, the remote control will be inoperative.

If the push button is “out”, the unit will power-up in Standby indicated by a RED light on the front panel.

The amplifier can be brought out of Standby by pressing the Standby push button on the remote control. A further press of the button will put the amplifier back into standby.

Diagram 3 - P2 rear panel and connection sockets

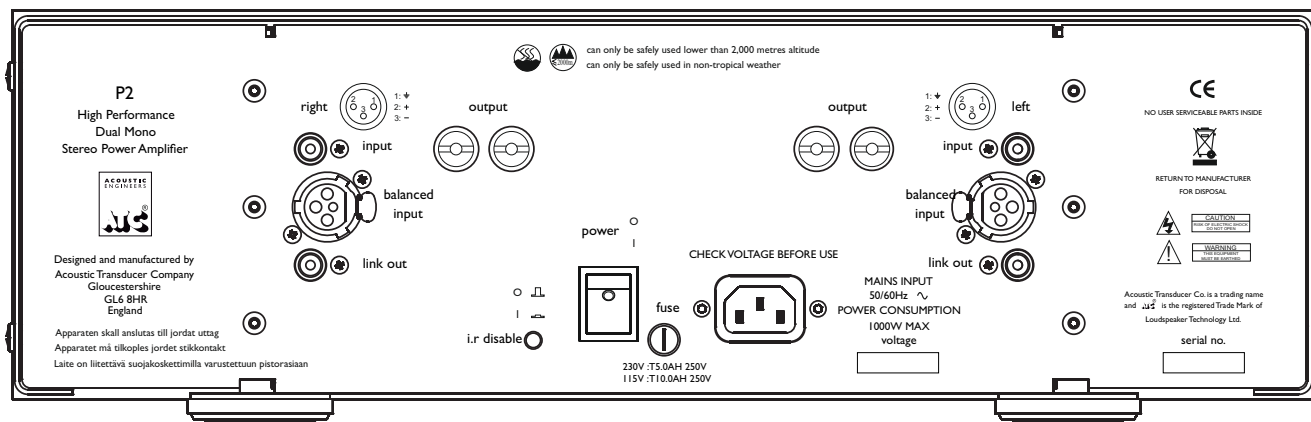
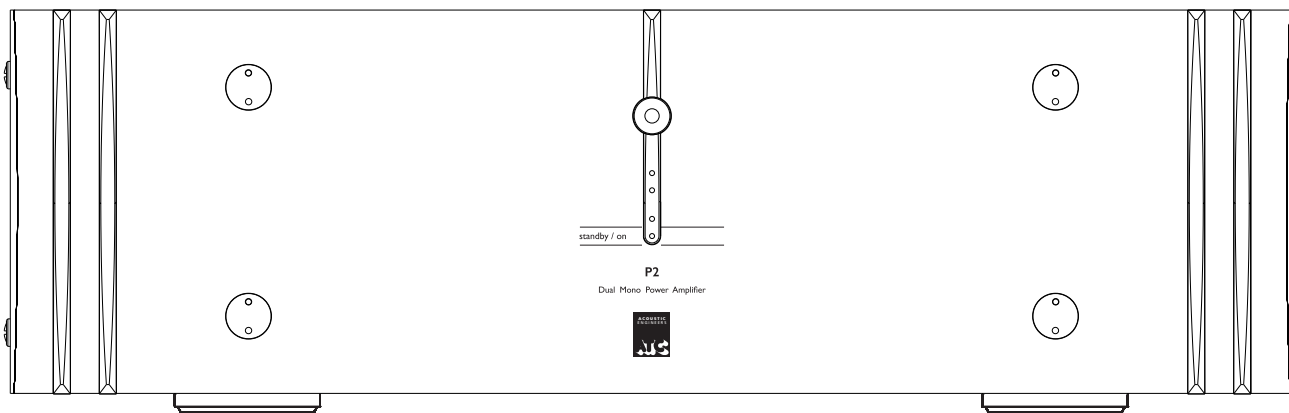

Diagram 4 - P2 front panel



3.5 Specifications

	PI	P2
Power Output (1% Distortion, 1kHz, Both channels driven, Continuous average)	>150W into 8 Ohms	>300W into 8 Ohms
Frequency Response (-3dB)	<2Hz – >400kHz	
Distortion (1kHz, 8 Ohms, 1dB below full power)	<0.002% (-95dB)	
Input Sensitivity (150 Watts, 8 Ohms, 1kHz)	2.0V/3dBV/4.1dBu	
Input Impedance	10k Ohms (Phono) 10k Ohms/Leg (XLR)	
S+N/N Ratio	>100dB (Wideband) >110dB (DIN) >115dB (IEC "A")	
Crosstalk (10Hz – 20kHz)	>100dB	
Damping Factor (8 Ohms)	>400	
Absolute Phase	Zero Degrees (Phono) Zero Degrees (XLR, Pin 2 Hot)	
XLR Common Mode Ratio (100Hz – 10kHz)	>60dB	
Power Requirements	115, 230V factory set, 50/60Hz	
Power Consumption	600W Maximum	1000W Maximum
Dimensions (H x W x D)	141 x 448 x 337mm 5.6 x 17.6 x 13.3in	141 x 448 x 337mm 5.6 x 17.6 x 13.3in
Weight	23kg/ 50.6lbs	25kg/ 55lbs

E & O.E. The policy of Loudspeaker Technology Ltd. is that of continuous design and development. We reserve the right to change specifications without prior notice.

4.1 Description

The SIA2-150 is a high quality integrated amplifier designed to partner ATC passive monitors and other Loudspeaker systems. It incorporates five line-level stereo inputs plus headphone jack, stereo record, pre and sub outputs on RCA phono sockets and one pair of loudspeaker outputs.

Input selection is achieved via a rotary control. Output volume adjustment is achieved by a precision potentiometer. Standby is accessible from a front panel push button. Mains power is applied from a rear panel mounted switch.

The SIA2-150 incorporates the same gain reduction and loudspeaker protection circuits as used in the ATC active monitors. This ensures that even working at very high levels the amplifier is held back from clipping so improving the subjective performance and protecting the loudspeakers from damage.

All SIA2-150 functions are duplicated on the included ATC remote control handset.

4.2 Inputs

The SIA2-150 accepts unbalanced RCA phono input plugs. The signal is present on the centre conductor of an unbalanced input and the signal return is made via the screened outer. If there is any hum present on the inputs, this must be traced to its source and not suppressed by the removal of screens or earths. Removal of the screen on an unbalanced input is likely to result in uncontrollably loud hum. The input sockets are illustrated in diagram 1.

All inputs are line level sensitivity via RCA phono connectors on the rear panel. Inputs are labeled CD, Tuner, AV, Aux., and Rec. in. However, they are electrically identical and a line level signal from any source equipment may be connected to any input.

4.3 Outputs

The SIA2-150 rear panel, illustrated in diagram 1, carries connectors for left and right loudspeakers, Rec. left and right outputs, Preamplifier left and right outputs and a left and right summed mono output.

Loudspeaker connections are made using the two pairs of proprietary ATC loudspeaker terminals. The positive terminal is coloured red and the negative terminal is coloured black. The left and right channels are clearly marked and correspond to the left and right inputs. The wire used for the connections to the monitors will have some identification for the positive conductor. Usually this is red, but may be a moulded stripe on the insulation.

Diagram 1 - SIA2-150 rear panel and connectors

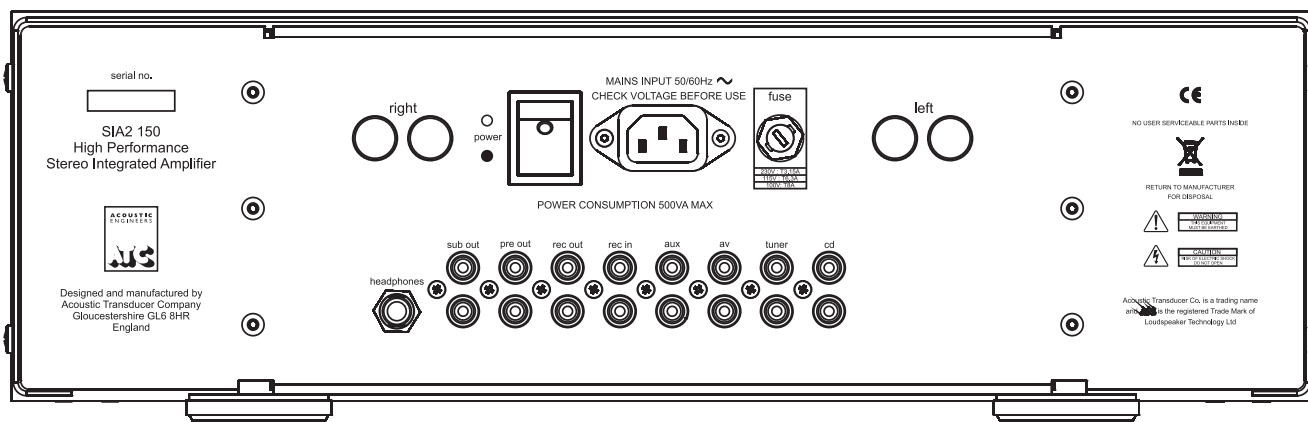
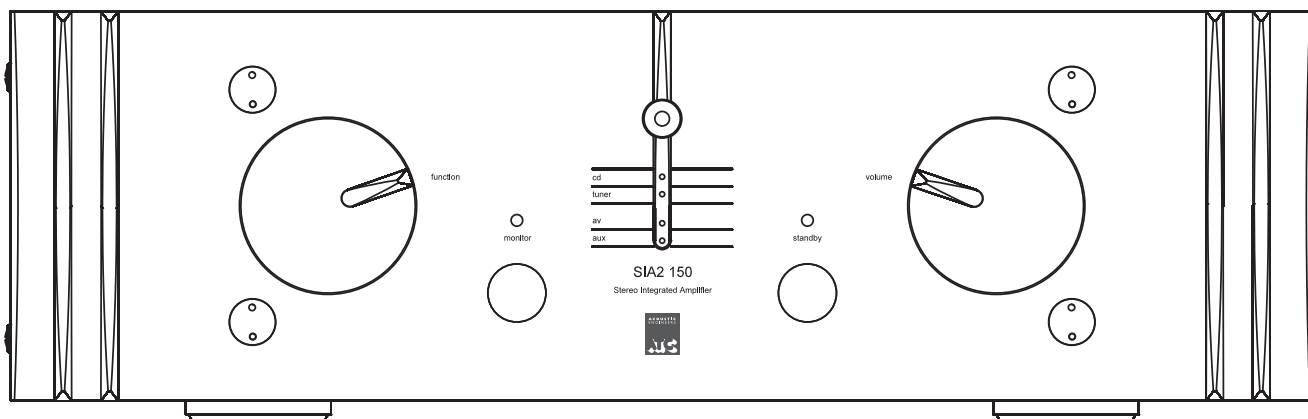

Diagram 2 - SIA2-150 front panel and controls



4.4 Operation

Once connected to mains power and powered up from the rear panel mains switch, the front panel Standby button (or remote handset Standby button) will switch the CA2 between standby and active mode. In Standby mode the Standby Indicator glows RED. Operating the Standby function from either the front panel or the remote handset will switch the CA2 into active mode. The RED indicator will extinguish and be replaced by the Input select indicator showing the current selection in GREEN. Operating the Standby function again will return the CA2 to Standby mode.

Inputs are selected by rotating the input select control in either direction. The control has continuous movement. When it is moved to the last input, further rotation will select the first input.

A separate tape loop is included with a Monitor option selected by a single push button on the front panel. The tape output will have the same signal as selected by the rotary input select control. Operation of the Standby or tape monitor controls will not affect this output providing mains power is maintained.

A pair of phono sockets on the rear panel can be used to drive another amplifier. A further pair of phono sockets can be used to drive a Sub channel Amplifier.

A Headphone output is provided via a 1/4" Jack socket to drive a variety of popular headphones. When headphones are connected the signal to the speakers, sub and pre out is muted.

Output level is controlled by the rotary Volume control on the front of the unit, the position of which is indicated by a black pointer. Rotating the control clockwise will increase the output level. It is good practice to lower the volume setting before switching on the preamplifier or any associated equipment, or while changing the input selection.

Due to the nature of the electronics in ATC amplifiers it is quite normal for a sound to be heard from the speaker when the power is applied or disconnected. The noise heard will not damage the speaker and is quite normal. Although ATC uses the highest-grade components, a different noise may be heard from each speaker due to slight tolerance variations in the amplifier components.

4.5 Specifications

Power Output (1% Distortion, 1kHz, Both channels driven, Continuous average)	>150 Watts
Frequency Response (-3dB)	<2Hz – >400kHz
Distortion (1kHz, 8 Ohms, 1dB below full power)	<0.002% (-95dB)
Input Sensitivity (150 Watts, 8 Ohms, 1kHz)	350mV
Input Impedance	20k Ohms
S+N/N Ratio	>100dB (Wideband)
Crosstalk (10Hz – 20kHz)	>90dB
Absolute Phase	Zero Degrees (Phono)
Power Requirements	100, 115, 230V factory set, 50/60Hz
Power Consumption	10VA Standby 500VA Maximum
Dimensions (H x W x D) (Including terminals)	135 x 435 x 350mm 5.31 x 17.1 x 13.8 inches
Weight	20kg/44lbs Net 22.2kg/48.8lbs Packed

E. & O.E. The policy of Loudspeaker Technology Ltd. is that of continuous design and development. We reserve the right to change specifications without prior notice.



Loudspeaker Technology Ltd Gypsy Lane, Aston Down, Stroud, Gloucestershire GL6 8HR United Kingdom

Telephone 01285 760561 Fax 01285 760683

Email: info@atc.gb.net Web: www.atcloudspeakers.co.uk